



## DIN Rail Housing

### Securely House DIN Rail Equipment in Rack Mount Environments

The DIN Rail Housing is designed to safely and securely house DIN rail mounted equipment for wall and rack mount applications. The industrial housing is a steel, powder coated, enclosure with a hinged transparent door for quick assessment of the equipment status and configuration. Access to the inside is easy and secure with a quarter turn latch. An optional key locking latch is also available.

Inside is a 15.8" section of standard 35mm DIN rail for mounting equipment. Multiple cable openings on the sides and bottom allow for flexible cable routing, and plastic cable guides are provided to manage copper and fiber cables into and out of the housing.

The housing may be ordered pre-configured with a 150 Watt AC/DC Power Supply system for either 24VDC or 48VDC applications. The power supply is pre-mounted on the DIN rail pre-wired with a breaker, terminal blocks, and a six foot AC pigtail power cord. Approximately 9.5 inches of DIN rail space is available after the power system is installed.

The RLH DIN Rail Housing is designed, engineered and built in the U.S.A.



*DIN Rail Housing*

#### Features

EIA 19/23" rack or wall mount (hardware included)

Durable powder coated steel construction

Quarter turn access latch or key locking latch option

Multiple cable entry and exit points for flexible routing

Front, side and rear vents

Hinged door with acrylic window to monitor equipment

15.8" of usable DIN rail space inside

Available with integrated AC/DC 150 Watt Powering System (24VDC or 48VDC options)

Designed, Engineered, and Built in the U.S.A.



## Dimensions

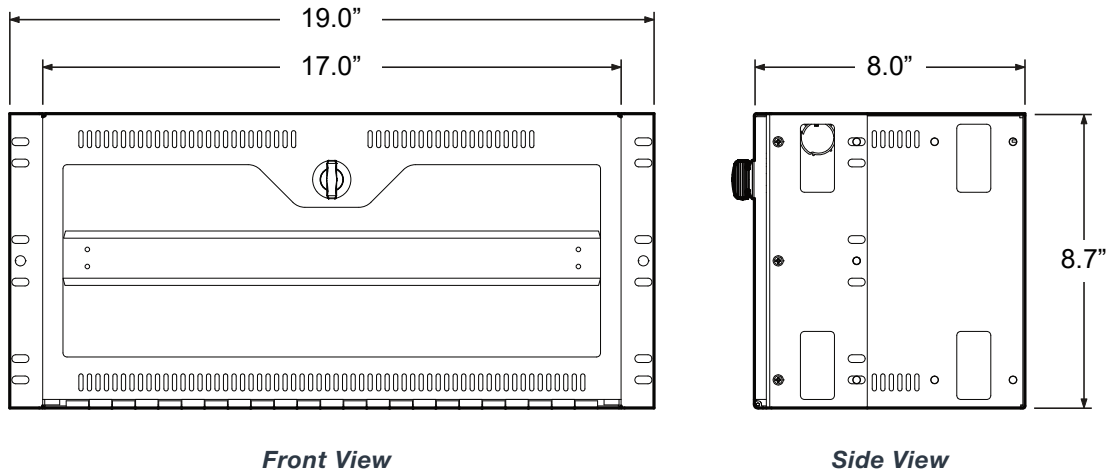

## Installation

Prior to Installation:

- Check for shipping damage
- Check the contents to ensure correct model and fiber type
- Have a clean, dry, installation environment ready

### Rack Mounting

Install the universal mounting brackets on the sides at the front for standard equipment racks, or half way back for Telco style rack mounting. For 23" rack applications, rotate the universal mounting brackets so the shorter end sits flat on the side of the housing before installing into the rack.

The housing includes (2) two universal mounting brackets and attaching hardware allowing the flexibility to fit into multiple application locations. Use the included #10-32 x .25" screws to attach the brackets to the housing. The #10-32 x .75" screws are used for mounting the housing to a 19" or 23" equipment rack, and the #12 x .75" screws are for wall or panel mounting. Cables may be routed through the rectangle entry and exit points on the sides, back and bottom of the housing.

### Standard Rack Mounting

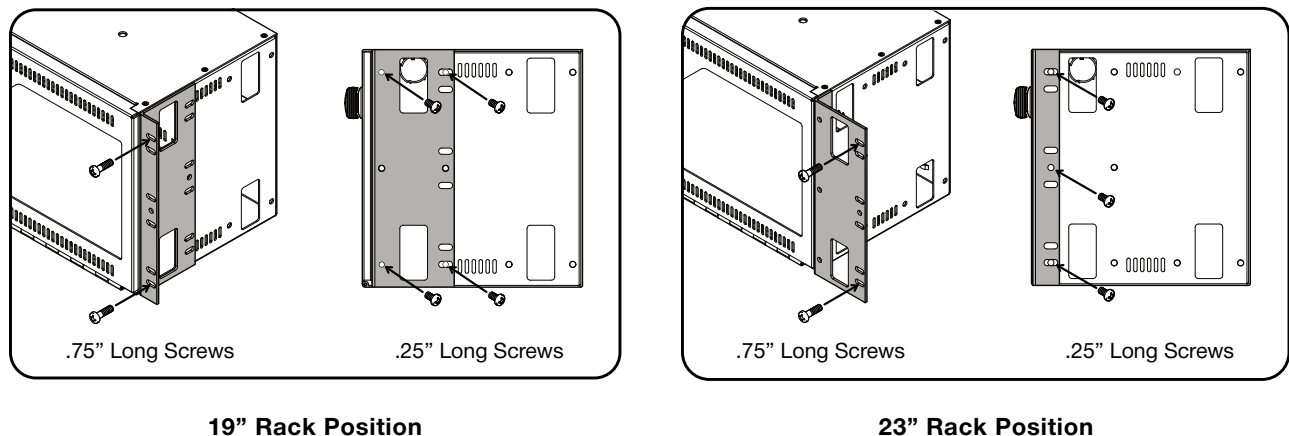

### Telco Style Rack Mounting

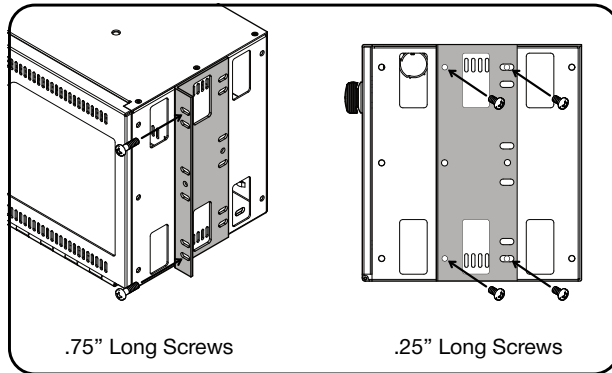

**19" Rack Position**

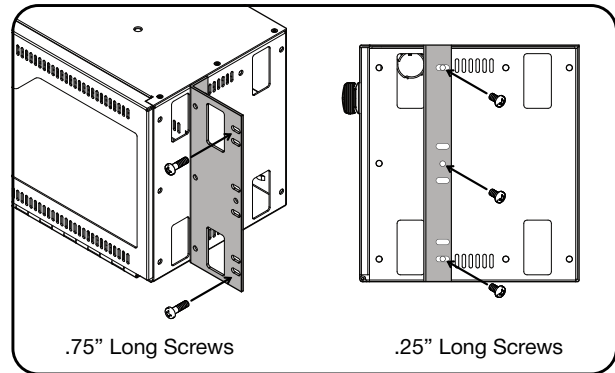

**23" Rack Position**

### Wall Mounting

Install the universal mounting brackets on the sides at the back of the housing. For wall mounting to wood backboard, use the included screws and flat washers. For all other mounting surfaces, use appropriate mounting hardware as required.

When installing, choose a location protected from the elements, and make sure there is sufficient room for the front door to open fully. Consider access to AC power, fiber cables, backup batteries and any other connections as required when installing.

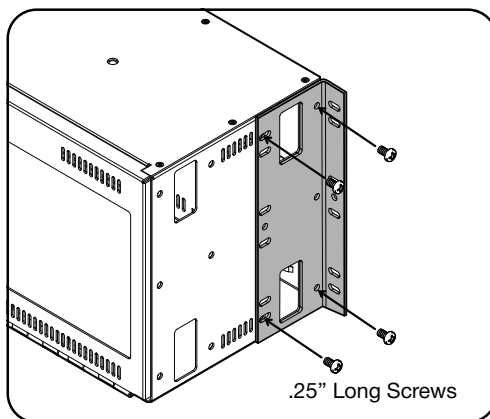

**Install Bracket**

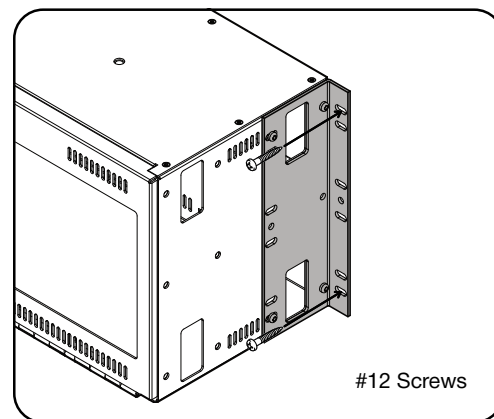

**Screw Into Wall**

## DIN Rail Mounting

The DIN clip for mounting the system is mounted onto the rear panel. Hook the DIN clip on the top flange of the DIN rail, press down and rotate to the locked position to install. To remove, push down to depress the spring latch and rotate off of the DIN rail.

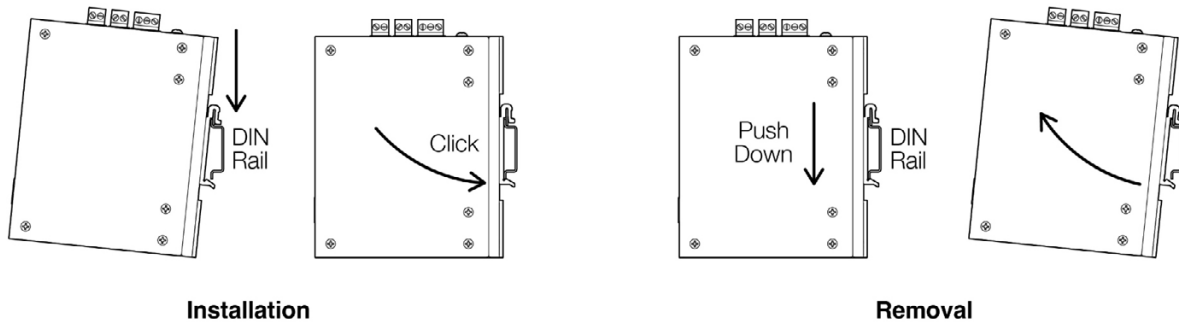

## AC/DC Power Supply Option

The housing may be ordered preconfigured with a 120 Watt AC/DC power supply system for either 24VDC or 48VDC applications. The power supply is premounted on the DIN rail prewired with a breaker, terminal blocks, and a six foot AC pigtail power cord. Plug the 6 ft. AC power cord into a standard 110V AC receptacle to apply power.

**Note:** The DC power outputs are live when AC or DC input power is present.

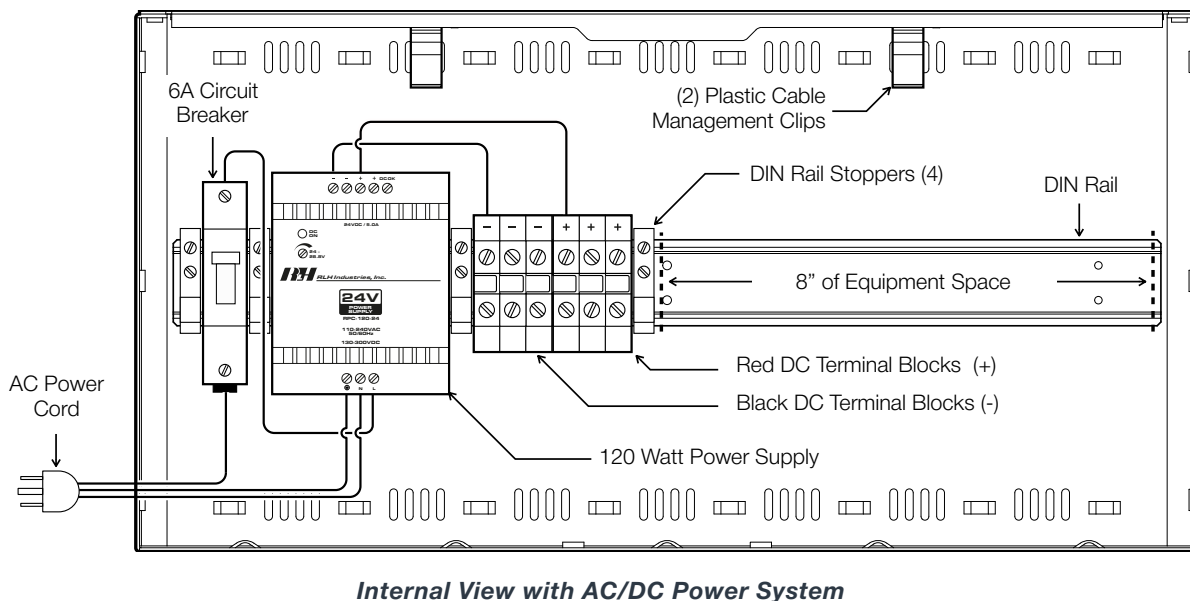



## General Specifications

### Housing Specifications

<b>Construction</b>	Powder coated steel, standard 35mm DIN rail, latching door with impact resistant polycarbonate window, and plastic cable guides
<b>Dimensions</b>	5RU - 17" (W) x 8" (D) x 8.7" (H), (432mm x 203mm x 221mm) (Interior mounting Space 15.8" of DIN rail space, 9.5" when ordered with integrated power supply)
<b>Included in Empty Housing</b>	Universal mounting brackets (19/23" rack / wall) and attaching hardware (keys for locking latch option)
<b>Included with Power System</b>	150 Watt AC/DC power supply, 6A Circuit Breaker, (2) red DC terminal blocks, (2) black DC terminal blocks, (4) DIN rail stoppers, 16AWG Wiring, 6ft AC power cord
<b>Compliance</b>	RoHS and REACH

### AC/DC Power Specifications

	Power Supply Model	RD1150-24F	RD1150-24F
Input	Voltage Range	Nominal 100-240VAC, 50 - 60Hz or 120 - 370VDC	
	Recommended Breaker	6A	
Output	DC Voltage	24VDC / 6.3A	48VDC / 3.2A
	Voltage Adj. Range	10%	
LED Indicators	DC output	Green: On	
Environment	Operating Temperature	-40°C to 40°C Full Load	40°C to 60°C Derating Curve Applies
	Humidity	5%~95% RH, Non-condensing	
Safety & EMC	UL 508, CSA 22.2, CE EN 60950		

## Ordering Information

Description	Part Number
DIN Rail Housing, Rack and Wall Mountable	<b>DRH-N-1</b>
DIN Rail Housing, Rack and Wall Mountable, with 150 Watt 24VDC Power Supply Kit	<b>DRH-N-24-1</b>
DIN Rail Housing, Rack and Wall Mountable, with 150 Watt 48VDC Power Supply Kit	<b>DRH-N-48-1</b>
DIN Rail Housing, Rack and Wall Mountable, with Key Lock	<b>DRH-S-1</b>
DIN Rail Housing, Rack and Wall Mountable, with Key Lock and 150 Watt 24VDC Power Supply Kit	<b>DRH-S-24-1</b>
DIN Rail Housing, Rack and Wall Mountable, with Key Lock and 150 Watt 48VDC Power Supply Kit	<b>DRH-S-48-1</b>

## Contact

<b>By Mail:</b>	ATTN: Sales RLH Industries, Inc. 936 N. Main Street Orange, CA 92867	
<b>By Phone:</b>	<b>Local</b>	714-532-1672
<b>Sales/Service</b>	<b>Toll Free</b>	800-877-1672
<b>By Email:</b>	info@fiber <sup>optic</sup> link.com	
<b>By Fax:</b>	714-532-1885	

## Support

<b>By Email:</b>	support@fiber <sup>optic</sup> link.com
<b>By Phone:</b>	Toll Free 855-754-2497